

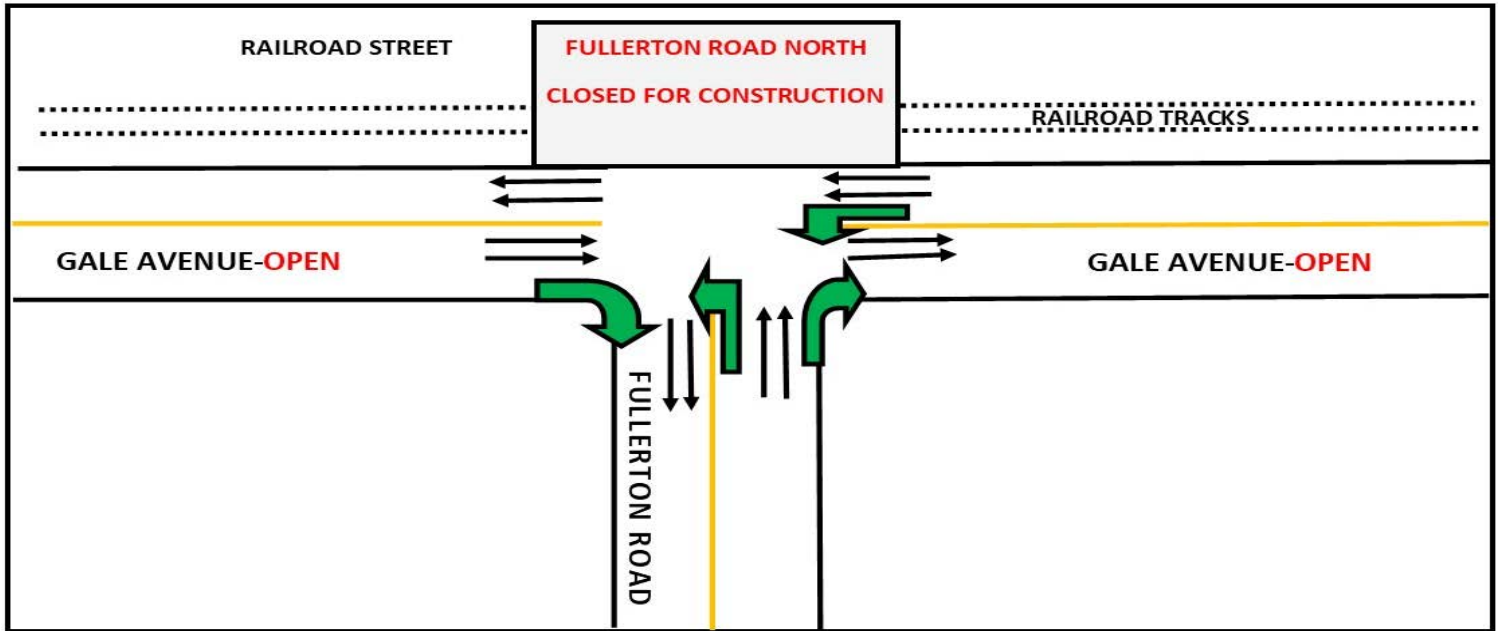

CONSTRUCTION ALERT

ALL EASTBOUND AND WESTBOUND TRAFFIC LANES ON GALE AVENUE BETWEEN PLAZA DRIVE AND JELICK AVENUE TO RE-OPEN TO TRAFFIC



WHAT

The Fullerton Road Grade Separation project contractor will complete all work along northbound and southbound Fullerton Road between State Route 60 and Gale Avenue and along eastbound and westbound Gale Avenue between Plaza Drive and Jellick Avenue, and will be re-opening the roadway to through traffic. In addition, work on the shoofly continues along the railroad and includes the closure of the multi-use path along the Union Pacific right of way. Preparations are also underway for the next construction phase, including the closure of north Fullerton Road between Rowland Street/San Jose Avenue and Arenth Avenue.

WHAT TO EXPECT

All lanes of the intersection will be open to through traffic and consist of two lanes in each direction and dedicated turn lanes along northbound and southbound Fullerton Road and eastbound and westbound Gale Avenue. New pedestrian paths along the new roadway will also re-open for public use. However, access north of Gale Avenue and along the railroad track is strictly prohibited while construction crews focus their efforts on completing the underpass. Motorists and pedestrians are encouraged to exercise caution while traveling by the construction activities.

WHEN

The traffic lanes are scheduled to re-open to traffic on **Monday, December 13, 2022** at 7:00 AM. The next phase of work that includes the closure of north Fullerton Road is tentatively planned to start in December 2022.

Para mas información o preguntas, por favor llame al teléfono directo o visite el sitio web en:



**For more information or questions, please call or visit:
(888) ACE-1426 or www.theaceproject.org**

Thank you for your patience and cooperation...**At ACE, it's Safety First!**

Note: Construction is a dynamic process and information is subject to change without notice.

Work activity is subject to weather conditions.